

BuckleyBrown
ESTATE AGENTS

£150,000

Yorke Street, Mansfield Woodhouse,
Mansfield,



Welcome to **BuckleyBrown**, where every home is carefully presented, so you can explore with clarity and confidence.

BuckleyBrown
ESTATE AGENTS

"Buyers are very often searching for that 'just move straight in' home — beautifully finished, close to town, packed with quality and style. Well, I'm sure this three bedroomed semi will catch your attention!"

- Jon, Director



IMMACULATELY REDECORATED & READY TO MOVE STRAIGHT INTO

Presented in immaculate condition throughout,

This beautifully semi-detached redecorated home makes an immediate impression with its immaculate frontage and pristine driveway, setting the tone for the exceptional presentation found throughout. Internally, the property offers spotless and thoughtfully arranged accommodation, finished to a high standard and perfectly suited to modern living, making it ideal for a range of buyers seeking both comfort and style.



THE FINER DETAILS

Beautifully redecorated throughout and presented in immaculate condition, this stunning home offers stylish and spacious accommodation ideal for modern family living.

The ground floor offers two versatile reception rooms, providing flexible living and entertaining space to suit a variety of lifestyles. A fully equipped kitchen is complemented by a handy utility area and a well-appointed bathroom, creating a practical and comfortable layout for everyday living.

Upstairs, the property boasts three generously sized bedrooms, all beautifully presented and offering ample space for families, guests, or those working from home.

Externally, the rear garden has been thoughtfully maintained and features a patio seating area, a well-kept lawn, and an attractive decorative palm tree, all enclosed by fence surround boundaries for added privacy and enjoyment.





BuckleyBrown
ESTATE AGENTS







LIFE IN MANSFIELD WOODHOUSE

Mansfield Woodhouse is a popular and well-established suburb located to the north of Mansfield town centre, offering a pleasant residential setting with a strong sense of local character. Combining everyday convenience with access to green spaces, the area appeals to a wide range of buyers seeking a balance between town living and community atmosphere.

The area itself has a proud heritage and a welcoming feel, centred around its historic High Street and traditional market place. Residents benefit from a variety of local amenities, including independent shops, supermarkets, schools and healthcare facilities, along with a selection of cafés, pubs and community services. This well-served environment makes Mansfield Woodhouse particularly attractive to families, first-time buyers and those looking to remain within an established community.

Surrounded by attractive countryside and green spaces, Mansfield Woodhouse is well suited to those who enjoy outdoor living. Nearby parks, woodland areas and open countryside provide opportunities for walking, cycling and recreation, while the wider Sherwood Forest area is easily accessible for longer countryside outings.



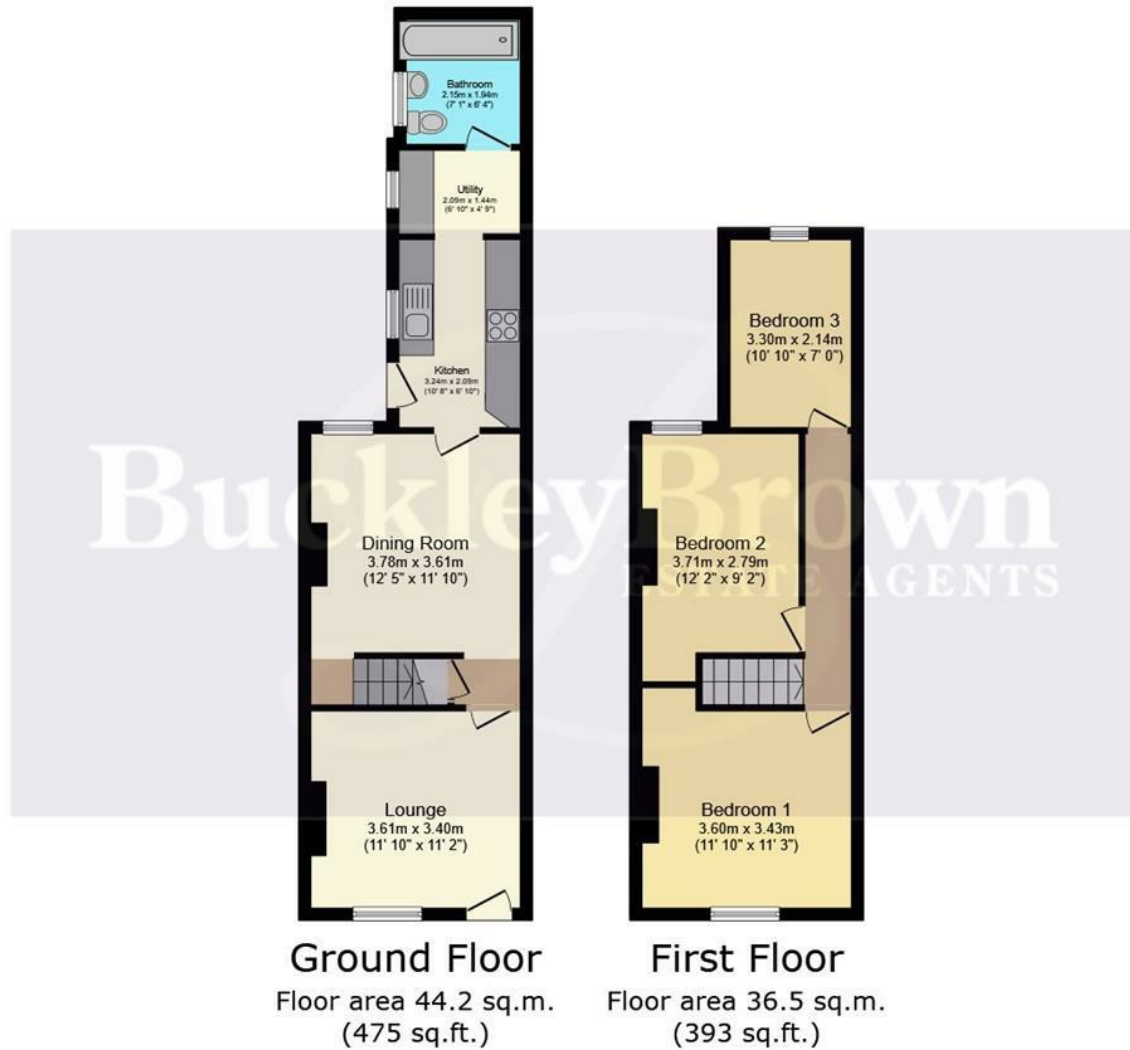

Total floor area: 80.7 sq.m. (868 sq.ft.)

This floor plan is for illustrative purposes only. It is not drawn to scale. Any measurements, floor areas (including any total floor area), openings and orientations are approximate. No details are guaranteed, they cannot be relied upon for any purpose and do not form any part of any agreement. No liability is taken for any error, omission or misstatement. A party must rely upon its own inspection(s). Powered by www.Propertybox.io

Key Features

Ready to move in condition

Fully redecorated throughout to a high standard

Two versatile reception rooms

Fully equipped kitchen with a utility room

Modern three piece bathroom on the ground floor

Enclosed lawn to the rear

Size

Approximately 80 sq.ft

BuckleyBrown
ESTATE AGENTS



These particulars are intended as a guide only and do not form part of any offer or contract. All descriptions, measurements, images and plans are provided for illustration purposes and should not be relied upon as statements of fact. Prospective purchasers should satisfy themselves as to the accuracy of the information. Buckley Brown Estate Agents accept no liability for any loss arising from reliance on these details.

© Buckley Brown Estate Agents 2026. All rights reserved.

Exceptional homes deserve
exceptional representation.

Let's Chat.

01623 633633

mansfield@buckleybrown.co.uk

[buckleybrown.co.uk](https://www.buckleybrown.co.uk)

BuckleyBrown
ESTATE AGENTS